

774 LM
BULKHEAD MALE CONNECTOR

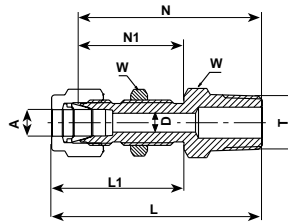

TUBE (METRIC) TO MALE NPT THREAD

Ordering Information	A Tube O.D.		T (NPT)		D		W Hex. Flat		N		N1		L		L1		Panel hole drill size		Max. panel thickness	
	mm	mm	in	mm	mm	mm	mm	mm	mm	mm	mm	mm	mm	mm	mm	mm	mm	mm	mm	mm
774LM _ 6 X 1/8	6		1/8		4.8		16		42.2		26.2		49.6		33.6		11.5		10.2	
774LM _ 6 X 1/4	6		1/4		4.8		16		46.2		26.2		53.6		33.6		11.5		10.2	
774LM _ 12 X 1/2	12		1/2		9.5		24		58.7		31.8		68.8		41.9		19.5		12.7	

TUBE (INCH) TO MALE NPT THREAD

Ordering Information	A Tube O.D.		T (NPT)		D		W Hex. Flat		N		N1		L		L1		Panel hole drill size		Max. panel thickness	
	in	mm	in	mm	in	mm	in	mm	in	mm	in	mm	in	mm	in	mm	in	mm	in	mm
774LM _ 1/8 X 1/8	1/8	3.17	1/8	.09	2.28	1/2	12.7	1.57	39.90	.97	24.60	1.83	46.48	1.23	31.24	21/64	8.33	.50	12.70	
774LM _ 1/4 X 1/8	1/4	6.35	1/8	.19	4.82	5/8	15.9	1.66	42.20	1.03	26.20	1.95	49.53	1.32	33.52	29/64	11.50	.40	10.16	
774LM _ 1/4 X 1/4	1/4	6.35	1/4	.19	4.82	5/8	15.9	1.84	46.70	1.03	26.16	2.13	54.10	1.32	33.52	29/64	11.50	.40	10.16	
774LM _ 3/8 X 1/4	3/8	9.52	1/4	.28	7.11	3/4	19.1	1.97	50.00	1.16	29.46	2.26	57.40	1.45	36.83	37/64	14.68	.44	11.17	
774LM _ 1/2 X 3/8	1/2	12.70	3/8	.40	10.40	15/16	23.8	2.09	53.10	1.25	31.75	2.49	63.25	1.65	41.91	49/64	19.44	.50	12.70	
774LM _ 1/2 X 1/2	1/2	12.70	1/2	.40	10.40	15/16	23.8	2.31	58.70	1.25	31.70	2.71	68.83	1.65	41.91	49/64	19.44	.50	12.70	

● "D" - Dimension is minimum opening. ● Dimensions are for reference only, and are subject to change without notice.