

774 L  
BULKHEAD UNION

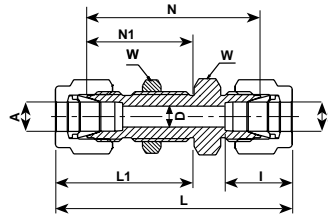

TUBE (METRIC) TO TUBE (METRIC)																				
Ordering Information	A		D		W		N		N1		L		L1		I		Panel hole drill size		Max. Panel thickness	
	Tube O.D.				Hex. Flat															
	mm	mm	mm	mm	mm	mm	mm	mm	mm	mm	mm	mm	mm	mm	mm	mm	mm	mm	mm	mm
774L_3	3		2.4		14		38.1		24.6		51.3		31.2		12.9		8.30		12.7	
774L_4	4		2.4		14		40.4		25.4		53.6		32.0		13.7		9.90		12.7	
774L_6	6		4.8		16		42.9		26.2		57.7		33.6		15.3		11.50		10.2	
774L_8	8		6.4		18		46.0		28.6		61.0		36.1		16.2		13.10		11.2	
774L_10	10		7.9		22		48.5		29.4		63.7		37.0		17.2		16.25		11.2	
774L_12	12		9.5		24		50.8		31.8		71.0		41.9		22.8		19.50		12.7	
774L_15	15		11.9		27		52.3		32.5		72.5		42.6		24.4		22.80		12.7	
774L_16	16		12.7		27		52.3		32.5		72.5		42.6		24.4		22.80		12.7	
774L_18	18		15.1		30		58.7		37.3		78.9		47.4		24.4		26.00		16.8	
774L_20	20		15.9		35		64.3		42.9		84.5		53.0		26.0		29.00		23.9	
774L_25	25		21.8		41		71.4		45.2		86.6		52.8		26.6		33.70		19.0	
TUBE (INCH) TO TUBE (INCH)																				
Ordering Information	A		D		W		N		N1		L		L1		I		Panel hole drill size		Max. Panel thickness	
	Tube O.D.				Hex. Flat															
	in	mm	in	mm	in	mm	in	mm	in	mm	in	mm	in	mm	in	mm	in	mm	in	mm
774L_1/16	1/16	1.58	.05	1.27	5/16	7.9	0.94	23.88	0.53	13.46	1.24	31.5	0.68	17.3	.34	8.6	13/64	5.16	.12	3.05
774L_1/8	1/8	3.17	.09	2.28	1/2	12.7	1.50	38.10	0.97	24.63	2.02	51.30	1.23	31.24	.50	12.7	21/64	8.33	.50	12.70
774L_3/16	3/16	4.76	.12	3.04	9/16	14.3	1.59	40.38	1.00	25.40	2.11	53.59	1.26	32.00	.54	13.7	25/64	9.92	.50	12.70
774L_1/4	1/4	6.35	.19	4.82	5/8	15.9	1.69	42.92	1.03	26.16	2.27	57.65	1.32	33.52	.60	15.2	29/64	11.50	.40	10.16
774L_5/16	5/16	7.93	.25	6.35	11/16	17.5	1.81	45.97	1.12	28.44	2.39	60.70	1.41	35.81	.64	16.2	33/64	13.09	.44	11.17
774L_3/8	3/8	9.52	.28	7.11	3/4	19.1	1.87	47.5	1.16	29.46	2.45	62.2	1.45	36.83	.66	16.8	37/64	14.68	.44	11.17
774L_1/2	1/2	12.70	.41	10.41	15/16	23.8	2.00	50.20	1.25	31.75	2.80	71.12	1.65	41.91	.90	22.9	49/64	19.44	.50	12.70
774L_5/8	5/8	15.87	.50	12.70	1 1/16	27.0	2.06	52.32	1.28	32.51	2.86	72.64	1.68	42.67	.96	24.4	57/64	22.62	.50	12.70
774L_3/4	3/4	19.05	.62	15.90	1 3/16	30.2	2.31	58.67	1.47	37.33	3.11	78.99	1.87	47.49	.96	24.4	1 1/64	25.79	.66	16.76
774L_1	1	25.40	.88	22.35	1 5/8	41.3	2.81	71.37	1.78	45.21	3.77	95.76	2.26	57.40	1.23	31.2	1 21/64	33.73	.75	19.05

● "D" - Dimension is minimum opening. ● Dimensions are for reference only, and are subject to change without notice.