

772 LF  
FEMALE BRANCH TEE

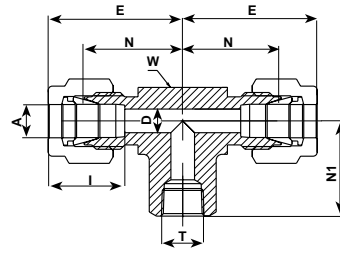

**TUBE (METRIC) TO FEMALE NPT THREAD**

Ordering Information	A Tube O.D.		T (NPT)	D		W Wrench Flat		N		E		N1		I	
	mm	in	in	mm	in	mm	in	mm	in	mm	mm	mm	mm	mm	mm
772LF _ 6 X 1/8	6		1/8	4.8		5/8	15.9		19.6		27.0		19.0		15.3
772LF _ 6 X 1/4	6		1/4	4.8		13/16	20.6		22.4		29.8		22.4		15.3
772LF _ 10 X 1/4	10		1/4	7.9		13/16	20.6		25.9		33.5		22.4		17.2
772LF _ 10 X 3/8	10		3/8	7.9		15/16	23.8		25.9		33.5		22.4		17.2
772LF _ 12 X 1/4	12		1/4	9.5		13/16	20.6		25.9		36.0		22.4		22.8
772LF _ 12 X 1/2	12		1/2	9.5		1 1/8	28.6		28.7		38.8		28.4		22.8
772LF _ 16 X 1/2	16		1/2	12.7		1 1/8	28.6		28.7		38.8		28.4		24.4

**TUBE (INCH) TO FEMALE NPT THREAD**

Ordering Information	A Tube O.D.		T (NPT)	D		W Wrench Flat		N		E		N1		I	
	in	mm	in	in	mm	in	mm	in	mm	in	mm	in	mm	in	mm
772LF _ 1/8 X 1/8	1/8	3.17	1/8	.09	2.28	5/8	15.9	.70	18.00	.97	24.64	.75	19.05	.50	12.7
772LF _ 1/4 X 1/8	1/4	6.35	1/8	.19	4.82	5/8	15.9	.77	19.56	1.06	26.96	.75	19.05	.60	15.2
772LF _ 1/4 X 1/4	1/4	6.35	1/4	.19	4.82	13/16	20.6	.88	22.35	1.17	29.71	.88	22.35	.60	15.2
772LF _ 3/8 X 1/4	3/8	9.52	1/4	.28	7.11	13/16	20.6	.94	23.88	1.23	31.24	.88	22.35	.66	15.2
772LF _ 1/2 X 1/4	1/2	12.70	1/4	.41	10.41	13/16	20.6	1.02	25.90	1.42	36.06	.88	22.35	.90	22.9
772LF _ 1/2 X 3/8	1/2	12.70	3/8	.41	10.41	15/16	23.8	1.02	25.90	1.42	36.07	.88	22.35	.90	16.8
772LF _ 1/2 X 1/2	1/2	12.70	1/2	.41	10.41	1 1/8	28.6	1.13	28.70	1.53	38.86	1.12	28.45	.90	22.9
772LF _ 5/8 X 1/2	5/8	15.87	1/2	.50	12.70	1 1/8	28.6	1.13	28.70	1.53	38.86	1.12	28.44	.96	22.9
772LF _ 3/4 X 3/4	3/4	19.05	3/4	.62	15.74	1 3/8	34.9	1.36	34.50	1.76	44.70	1.25	31.75	.96	24.4
772LF _ 1 X 3/4	1	25.4	3/4	.88	22.35	1 3/8	34.9	1.45	36.83	1.93	49.02	1.25	31.75	1.23	24.4
772LF _ 1 X 1	1	25.4	1	.88	22.35	1 11/16	42.9	1.63	41.40	2.11	53.60	1.50	38.10	1.23	31.2

● "D" - Dimension is minimum opening. ● Dimensions are for reference only, and are subject to change without notice.