

LET-LOK TUBE FITTINGS

764 L UNION TEE

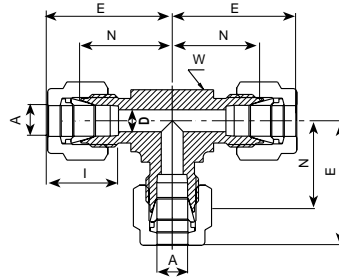

ALL TUBE (METRIC)

Description	A		D		W		N		E		I	
	Tube O.D.				Wrench Flat							
	mm	mm	mm	mm	in	mm	mm	mm	mm	mm	mm	mm
764L_2	2		1.7		3/8	9.5	15.7		22.3		12.9	
764L_3	3		2.4		3/8	9.5	15.7		22.3		12.9	
764L_4	4		2.4		1/2	12.7	18.8		25.4		13.7	
764L_6	6		4.8		1/2	12.7	19.6		27.0		15.3	
764L_8	8		6.4		5/8	15.9	22.4		29.9		16.2	
764L_10	10		7.9		11/16	17.5	23.9		31.5		17.2	
764L_12	12		9.5		13/16	20.6	25.9		36.0		22.8	
764L_14	14		11.1		15/16	23.8	28.7		38.8		24.4	
764L_15	15		11.9		15/16	23.8	28.7		38.8		24.4	
764L_16	16		12.7		15/16	23.8	28.7		38.8		24.4	
764L_18	18		15.1		1 1/8	28.6	29.7		39.8		24.4	
764L_20	20		15.9		1 3/8	34.9	34.5		44.6		26.0	
764L_22	22		18.3		1 3/8	34.9	34.5		44.6		26.0	
764L_25	25		21.8		1 3/8	34.9	36.8		49.1		31.3	

ALL TUBE (INCH)

Description	A		D		W		N		E		I	
	Tube O.D.				Wrench Flat							
	in	mm	in	mm	in	mm	in	mm	in	mm	in	mm
764L_1/16	1/16	1.58	.05	1.27	3/8	9.5	.56	14.22	.70	17.80	.34	8.6
764L_1/8	1/8	3.17	.09	2.28	3/8	9.5	.62	15.74	.88	22.35	.50	12.7
764L_3/16	3/16	4.76	.12	3.04	1/2	12.7	.70	17.80	.96	24.40	.54	13.7
764L_1/4	1/4	6.35	.19	4.82	1/2	12.7	.77	19.55	1.06	26.90	.60	15.2
764L_5/16	5/16	7.93	.25	6.35	5/8	15.9	.88	22.35	1.17	29.71	.64	16.3
764L_3/8	3/8	9.52	.28	7.11	5/8	15.9	.91	23.11	1.20	30.48	.66	16.8
764L_1/2	1/2	12.70	.41	10.41	13/16	20.6	1.02	25.90	1.42	30.10	.90	22.9
764L_5/8	5/8	15.87	.50	12.70	15/16	23.8	1.13	28.70	1.53	38.90	.96	24.4
764L_3/4	3/4	19.05	.62	15.74	1 1/8	28.6	1.17	29.70	1.57	39.90	.96	24.4
764L_7/8	7/8	22.22	.72	18.29	1 3/8	34.9	1.36	34.54	1.76	44.70	1.02	25.9
764L_1	1	25.40	.88	22.35	1 3/8	34.9	1.45	36.80	1.93	49.00	1.23	31.2
764L_1 1/4	*1 1/4	31.75	1.09	27.7	1 11/16	42.9	1.75	44.50	2.67	67.80	1.62	41.1
764L_1 1/2	*1 1/2	38.10	1.34	34.0	2	50.8	2.00	50.80	3.10	78.74	1.97	50.0

* Including low friction paste, See page 12 • "D" - Dimension is minimum opening. • Dimensions are for reference only, and are subject to change without notice.