

# LET-LOK TUBE FITTINGS

## 7102 L UNION CROSS

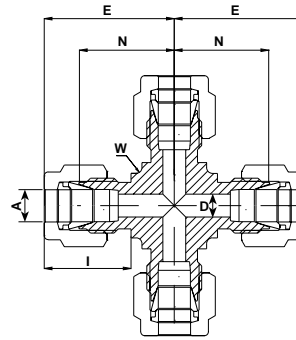

### ALL TUBES (METRIC)

Ordering Information	A		D		W		N		E		I	
	Tube O.D.		mm		Wrench Flat		mm		mm		mm	
	mm	mm	mm	mm	in	mm	mm	mm	mm	mm	mm	mm
7102L_3	3		2.4		3/8	9.5			15.7			12.9
7102L_6	6		4.8		1/2	12.7			19.6			15.3
7102L_8	8		6.4		5/8	15.9			22.4			16.2
7102L_10	10		7.9		13/16	20.6			25.9			17.2
7102L_12	12		9.5		13/16	20.6			25.9			22.8
7102L_18	18		15.1		1 1/16	27.0			28.2			24.4
7102L_20	20		15.9		1 3/8	34.9			34.5			26.0

### ALL TUBES (INCH)

Ordering Information	A		D		W		N		E		I	
	Tube O.D.		in		Wrench Flat		in		in		in	
	in	mm	in	mm	in	mm	in	mm	in	mm	in	mm
7102L_1/8	1/8	3.17	.09	2.28	3/8	9.5	.62	15.74	.88	22.35	.50	12.7
7102L_1/4	1/4	6.35	.19	4.82	1/2	12.7	.77	19.56	1.06	26.92	.60	15.2
7102L_5/16	5/16	7.93	.25	6.35	5/8	15.9	.88	22.35	1.17	29.71	.64	16.2
7102L_3/8	3/8	9.52	.28	7.11	5/8	15.9	.91	23.11	1.20	30.48	.66	16.8
7102L_1/2	1/2	12.70	.41	10.41	13/16	20.6	1.02	25.9	1.42	36.07	.90	22.9
7102L_3/4	3/4	19.05	.62	15.74	1 1/16	27.0	1.17	29.72	1.57	39.88	.96	24.4
7102L_1	1	25.40	.88	22.35	1 3/8	34.9	1.45	36.8	1.93	49.02	1.23	31.2

● "D" - Dimension is minimum opening. ● Dimensions are for reference only, and are subject to change without notice.